

Contents 內容物

- | | |
|--------------------------------------|---------------|
| ① Main Unit (Oil Stick included) × 1 | 擴香機本體 (含精油棉棒) |
| ② USB Cable × 1 | USB電源線 |
| ③ Replacement Oil Sticks × 2 | 替換精油棉棒2入 |
| ④ Dropper Opener × 1 | 精油瓶開瓶器 |
| ⑤ Instruction Manual × 1 | 說明書 |

Part names 部件名稱

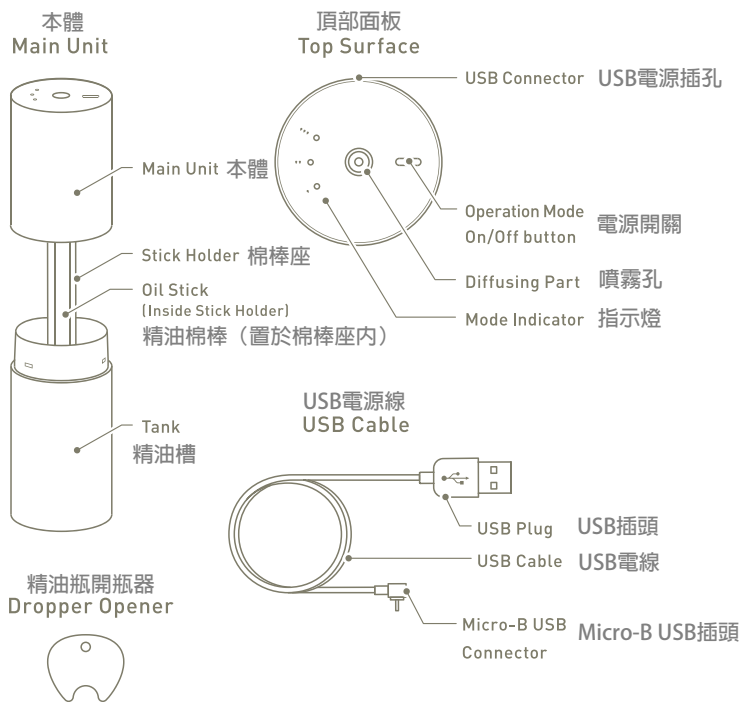

Designated aroma oil 特製香氛精油



Please use "Piezo diffuser aroma oil" for solo. Piezo diffuser aroma oil is designed with 100% pure natural essential oils and fermentation ethanol for smooth diffusion.

請使用特製的Piezo專用香氛精油，以達到最佳的精油擴散效果 (100%純天然精油，配合植物性發酵醇類調和而成)

Preparation 使用前的準備

Add Piezo diffuser aroma oil to the tank 將Piezo精油倒入精油槽

1. Remove the tank and main unit. Rotate the ▲ mark on the side of the tank to the position of the unlock mark on the side of the body and lift the body up (Figure 2).

! To prevent malfunction, please remove the USB cable from the main unit and pour Piezo diffuser aroma oil.

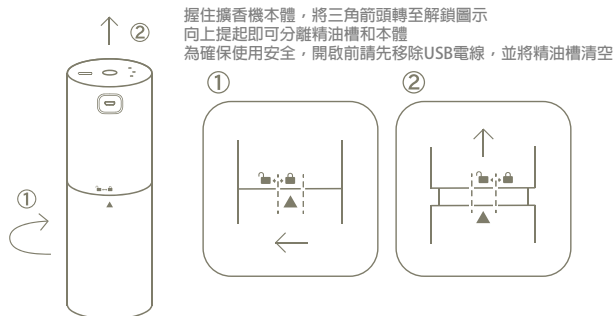

將Piezo精油倒入精油槽 (上限180ml) 請使用內附之開瓶器移除精油瓶安全蓋

2. Pour Piezo diffuser aroma oil into the tank (Up to 180ml). When removing the dropper from the oil bottle, please use the included dropper opener.



將精油槽裝回本體，將三角箭頭轉至鎖定圖示

3. Attach the main unit to the tank. Slide the body of the unit to the locked mark.

! Make sure that the main unit and the tank are securely attached. 請務必確認精油槽和本體為緊密接合之狀態

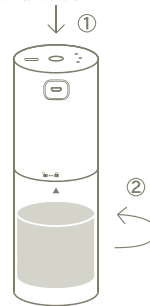

Connect USB power supply 連接USB電源線

1. Connect the Micro-B USB connector of the USB cable to the USB connector on the main unit.

! Please note the direction of the USB connector when connecting.

將Micro-B端插入擴香機本體電源插孔
插入時請注意接頭方向

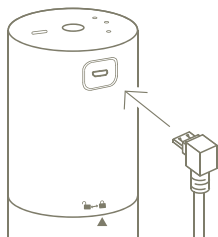

2. Connect the USB plug of the USB cable to the USB port of a PC or a USB power adapter. 將USB端插入電腦的USB孔，或插入USB轉接插頭

! Please purchase separately a USB power adapter that can supply output current of 1A or more. 請使用輸出電流1A以上之USB轉接插頭（例如一般智慧手機用轉接頭）

! When connecting to a PC, please connect with the PC fully started up. It may not operate even if connected to a PC in standby mode.

如連接電腦USB孔，請確認電腦處於正常開機狀態，待機或休眠模式可能導致擴香機無法正常運轉

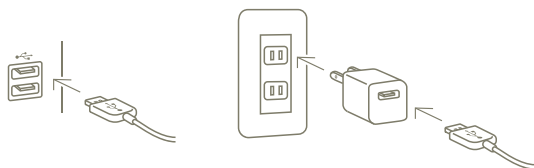

How to operate 運轉模式

Start Operation 開啟運轉

Press the operation mode on/off button. The operation mode (indicator) changes in the following order.

按下電源開關開機即可噴霧，可利用按鈕選擇3種運轉模式（3種指示燈依序切換，如下圖）



! It may take up to 10 minutes for Piezo diffuser aroma oil to saturate the stick if you are operating in a dry condition, such as when you are using for the first time or after replacing the oil stick. (It may take more time when a small amount of Piezo diffuser aroma oil was poured into the tank.)

如使用全新的精油棉棒，則開機後須等待一段時間始能正常噴霧（10分鐘左右）
若精油槽中精油含量較少，等待時間可能更長

Refill oil 補充精油

When Piezo diffuser aroma oil decreases (when spraying stops), remove the USB cable and refill the oil according to the procedure "Add Piezo diffuser aroma oil to the tank" (Page.5).

* A small amount of oil remains in the tank (due to shape of tank).

* When refilling the oil in the tank, we recommend that you use a funnel (glass or PP), so that it will not spill.

當Piezo精油餘量不足（停止噴霧時），移除USB電線並補充新的Piezo精油（參照第5頁說明）
精油槽可能殘餘少量精油

補充精油時，建議搭配玻璃或PP材質的漏斗，避免傾倒漏液

ON / OFF of LED lighting 開 / 關LED燈

When you press and hold the operation mode switching button during operation, you can turn off the LED lighting. To turn it on again, press and hold the button in the same way.

按住開關按鈕（約3秒）可開啟或關閉本體內的LED燈光
光源置於本體內部，明亮處使用較不明顯

Maintenance 日常保養

Clean the tank 清潔精油槽

Rinse the tank several times with tap water. If the inside of the tank is dirty, please wash with mild detergent, soft brush or sponge. Please dry well before use.

精油槽可使用自來水沖洗潔淨

若槽內有污垢，請使用軟海綿沾取中性清潔液擦拭，沖洗後置於通風處晾乾

Clean the diffusing part 清潔噴霧孔

Gently remove the dirt adhering to the diffusing part with a cotton swab. Excessive force may cause damage to the diffusing part. If it is dirty, please immerse the swab into the diffuser cleaner (sold separately) or absolute ethanol and clean it.

請使用棉花棒輕柔擦拭噴霧孔，以去除沾附的灰塵，力道過大可能會傷害噴霧孔

若噴霧孔附著髒汙，請以棉花棒沾取專用清潔液（另售）或市售無水乙醇，輕柔地擦除

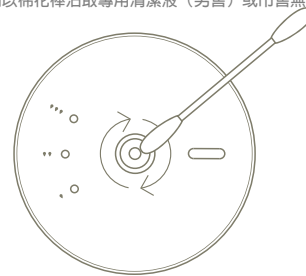

Clean the main unit 清潔本體

Please wipe with a soft cloth. Wipe off the dirt with a wrung out neutral detergent soaked cloth, then wipe with a clean cloth to rinse off the detergent from the main unit. Dry well before use.

請以軟布擦拭機器本體，若有髒汙時請以軟布沾中性清潔液，擰乾後擦除

建議以另一塊軟布再擦拭過，避免清潔劑殘留
清潔後請置於通風處晾乾再使用

When not in use for a long time 當長期不用欲封存時

1. After cleaning, dry thoroughly so that moisture does not remain in the main unit, tank, oil stick. 清潔後務必確保本體、精油槽、精油棒皆已通風乾燥
2. Place the main unit in a moisture-proof bag such as a plastic bag, store it in a place that avoids dust, high temperatures, high humidity, and direct sunlight.

! Please do not store it without sufficiently drying it. It may cause mold and odor.

將本體置入不易受潮的儲存袋（例如厚質塑膠夾雜袋）
避免存放於以下位置：灰塵較多、日光直射、高溫或潮濕處
未完全乾燥前請勿收納，否則機器可能發黴或發臭

Replacing the oil stick 更換精油棉棒

If you wish to change the type of oil or if the amount diffused has decreased significantly despite the fact that there is a sufficient amount of oil in the tank, please replace with a new oil stick.

當欲更換不同香味的精油時，或精油槽仍有液體，但棉棒已劣化導致噴霧效果不佳時，請更換棉棒

1. Follow the procedure "Add Piezo diffuser aroma oil to the tank" (Page.5) and remove the tank and main unit. 參照第5頁指示，分離本體及精油槽
2. Open the cap at the bottom of the stick holder. 打開棉棒座底部的蓋子

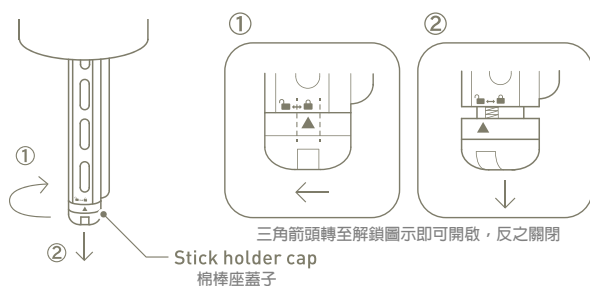

3. After pulling out the old oil stick, insert a new oil stick and attach the cap. 取出舊的精油棉棒後，置入新的棉棒並蓋上蓋子

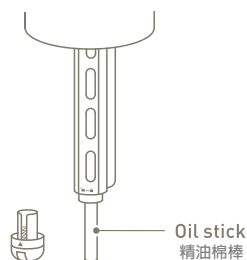

! Please handle gently when inserting oil stick. If it bends or deforms it may not spray properly.

! The spring inside the cap is an important part for the spray operation. If it detaches, reattach it to the cap.

請小心拿取棉棒，若折損變形恐影響噴霧效果
棉棒座蓋子內的小彈簧是機器噴霧功能的重要零件，若不慎掉落請務必安裝回去

Troubleshooting 障礙排除

Issue 問題	Check item / Approach 檢查項目及處理方式
Does not turn on 機器無法開啟	Is the USB power supply properly connected? → Follow the procedure of "Connect USB power supply" (Page.6) and connect the USB power supply correctly.
Does not diffuse 機器無法噴霧	Is the Oil Stick properly installed? → Follow the procedure of "Replacing the Oil Stick" (Page.8) and install the stick correctly. When replacing with a new stick it may take up to 10 minutes to begin diffusing. (It may take more time when only a small amount of Piezo diffuser aroma oil was poured into the tank.)
Does not diffuse 機器無法噴霧	Is Piezo diffuser aroma oil missing in the tank? → Please refill Piezo diffuser aroma oil according to the procedure "Add Piezo diffuser aroma oil to the tank" (Page. 5).
Does not diffuse 機器無法噴霧	Is there residual oil or dust on the diffusing part? → Using a cotton swab, soaked with cleaner, lightly wipe the diffusing part according to "Clean the diffusing part" (Page.7).
The mode indicator flashes as shown below	LED指示燈如下閃爍時（2顆燈） → The USB power supply voltage is too low. Make sure that the USB power supply is functioning correctly. USB供電過於微弱，請確認電源插座是否正確
All of the mode indicators are flashing	LED指示燈如下閃爍時（3顆燈） → An abnormality has occurred in the main unit. Please contact the sales outlet from which you purchased the product. 機器異常，請聯絡購買門市

Product specifications

Model	BM-E20A
Power	DC 5 [V]
Current ※2	0.5 [A] or lower
Operation mode	Low-diffuses every 60 seconds Medium-every 20 seconds High-every 10 seconds
Oil consumption ※3	Low 0.3 Medium 1.0 High 2.0 [mL/h]
Auto-Off	Turns off in 12 hours
Size	Diameter 65 × Height 190 [mm]
Weight	320[g] Main unit (not including oil)