

Canopy

by Mater

mater

For this product you will need two screws and two plugs in addition to the components that are included.

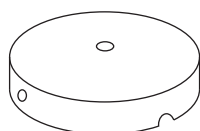
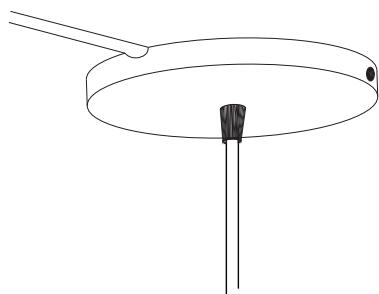

1 x ceiling cap



1 x cord grip sleeve



2 x screws

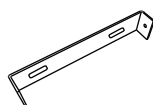

1 x ceiling bracket



1 x cord grip



1 x bolt

1

Drill holes and insert wall plugs and screw the bracket into the ceiling.

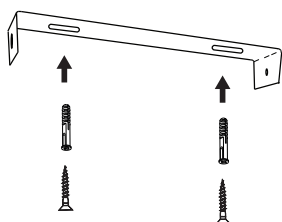

2

Pull the cord grip sleeve on to the cord as shown.

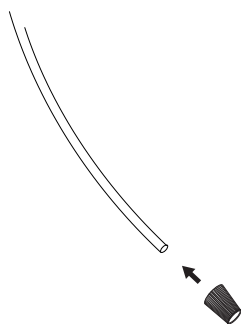

3

Fix the cord grip and bolt on to the ceiling cap.

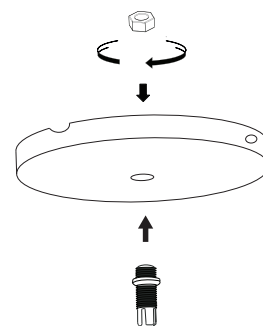

4

Pull the pendant's cord at the desired length, fix the cord grip sleeve in place and tighten.

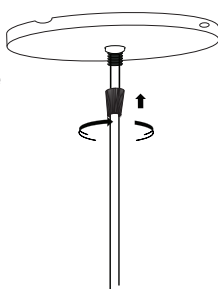

5

Use the supplied screws to seal the ceiling cap to the bracket mounted in the ceiling.

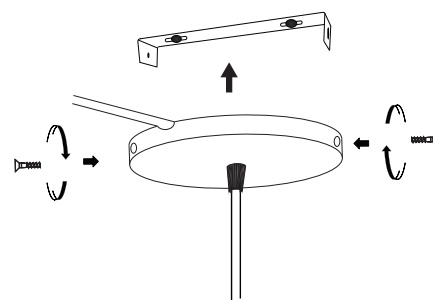

Changing light bulb for Terho Small

1

Separate the top from the glass.

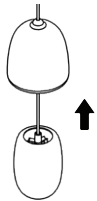

2

Grab the handle of the bulb and pull outwards. Do not be afraid to apply necessary force.

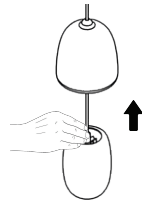

3

Unwind the bulb to replace it with a new one.

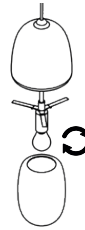

4

To place the bulb back in the glass, converge the arms of the clamp by pushing them downwards.



5

Insert the clamp into the glass. You can release your grip when the clamp is almost halfway inside the glass.

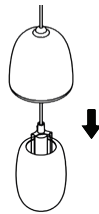

6

Push the clamp into the glass until it is fully inside. Then, connect the top with the glass.



7

Push the glass upwards or sideways with the palm of your hand to orientate it into a straight position.

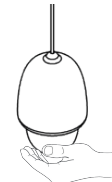

Changing light bulb for Terho Medium / Large

1

Lift the top from the glass.

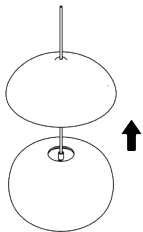

2

Grab the disc of the socket and move to one side of the glass.

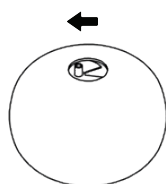

3

Tilt the disc and glide glass into the gap.

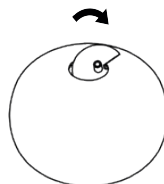

4

Twist the disc outwards.

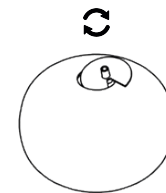

5

Once the disc is out, unwind the bulb to replace it with a new one.

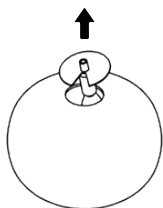

6

To place the socket back in the glass, proceed in the reverse order and glide the wooden top in place.

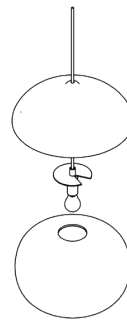

7

Push the glass upwards or sideways with the palm of your hand to orientate it into a straight position.

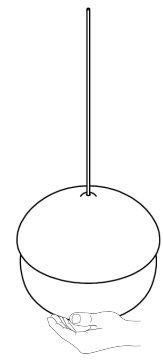

EU: E14 (small) - E27 (Medium & Large). UL: E12 (Small) - E26 (Medium & Large) **Bulb not included.**

Do not use regular bulbs as the wooden part will cause overheating. Max 6W LED. 220-240V. ac 50Hz.

For installation please consult your local electrician.

WHY LED?

LED lighting reduce environmental impact, resulting in power management solutions that are safe, reliable and efficient. Upgrading lighting to LED not only saves you up to 85 % in energy costs, but also reduces waste going to landfill and greenhouse gas emissions.