

Canopy

by Mater

mater

For this product you will need two screws and two plugs in addition to the components that are included.

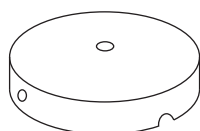
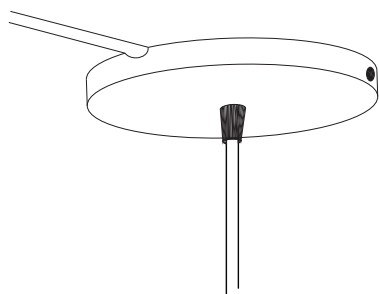

1 x ceiling cap



1 x cord grip sleeve



2 x screws

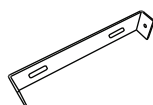

1 x ceiling bracket



1 x cord grip



1 x bolt

1

Drill holes and insert wall plugs and screw the bracket into the ceiling.

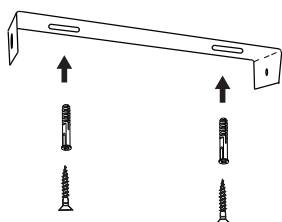

2

Pull the cord grip sleeve on to the cord as shown.

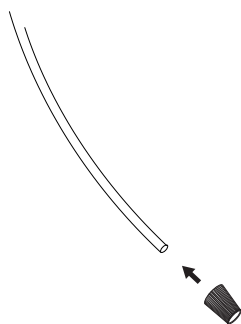

3

Fix the cord grip and bolt on to the ceiling cap.

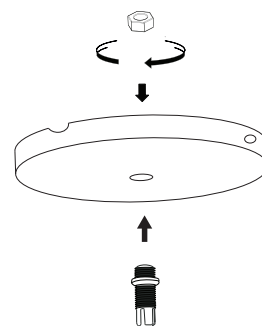

4

Pull the pendant's cord at the desired length, fix the cord grip sleeve in place and tighten.

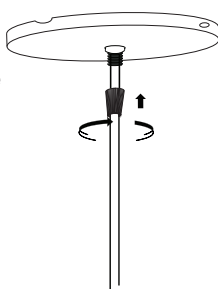

5

Use the supplied screws to seal the ceiling cap to the bracket mounted in the ceiling.

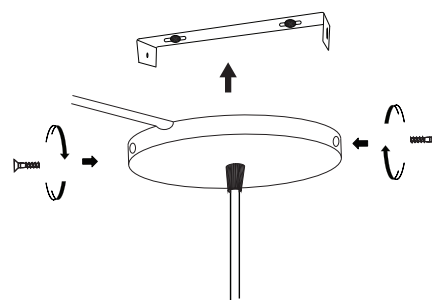

Liuku

by Maija Puoskari

mater

Changing light bulb* of the wooden Liuku Drop

1

Separate the glass from wooden base.

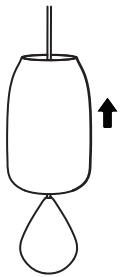

2

Pull the bulb with the cord out of the wooden base.



3

Unwind the bulb to replace it with a new one.

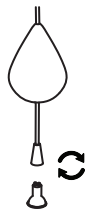

4

Push the bulb with the cord back into the wooden base.



5

Slide the glass back to place nestling on the wooden base.

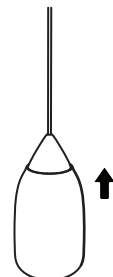

Changing light bulb* of the wooden Liuku Ball

1

Separate the glass from wooden base.

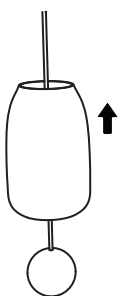

2

Pull the bulb with the cord out of the wooden base.



3

Unwind the bulb to replace it with a new one.



4

Push the bulb with the cord back into the wooden base.



5

Slide the glass back to place nestling on the wooden base.

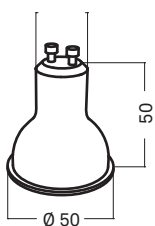
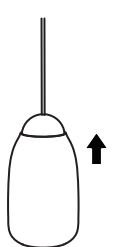

*LED Bulb included (GU10). For installation please consult your local electrician.

Use only GU10. Max 9W LED, 220-240V. ac 50Hz.

Do not use regular bulbs.

WHY LED?

LED lighting reduce environmental impact, resulting in power management solutions that are safe, reliable and efficient. Upgrading lighting to LED not only saves you up to 85 % in energy costs, but also reduces waste going to landfill and greenhouse gas emissions.